

SITE PLAN OF INDUSTRIAL
 DEPARTMENT OF INDUSTRIES
 DISTRICT INDUSTRIES CENTER
 (NOT TO SCALE)

ESTATE SOPORE
 AND COMMERCE
 BARAMULLA

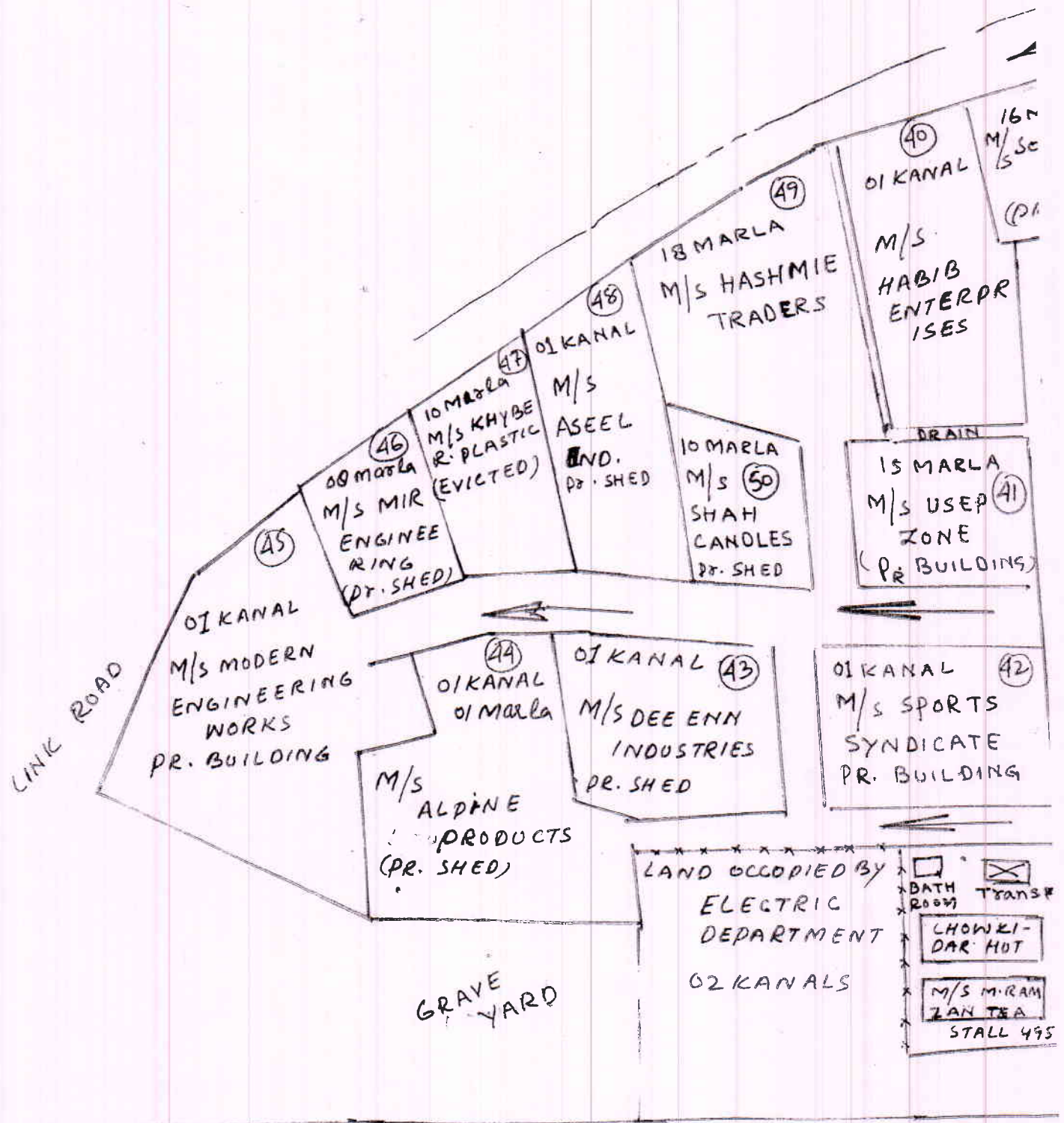

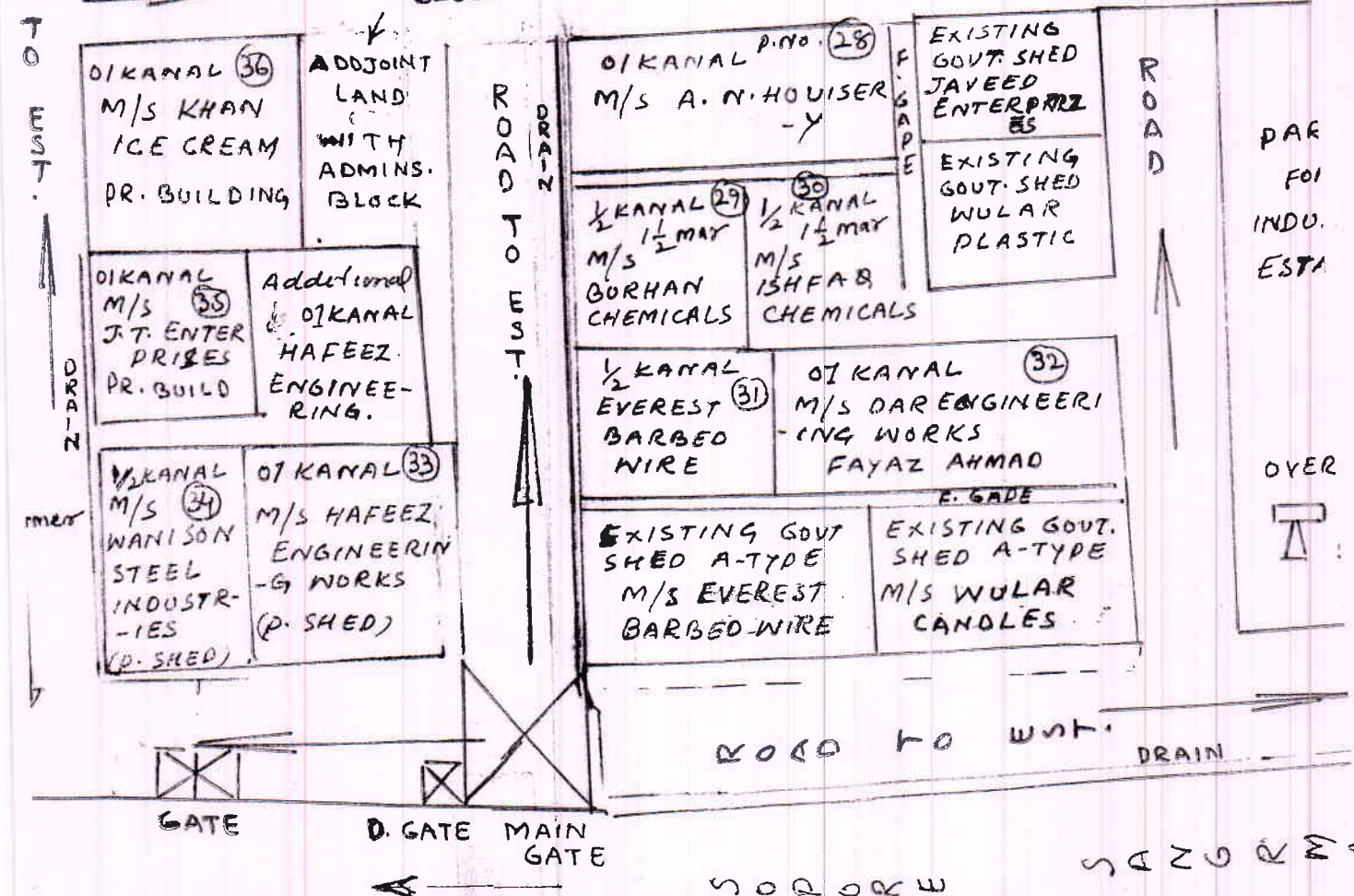
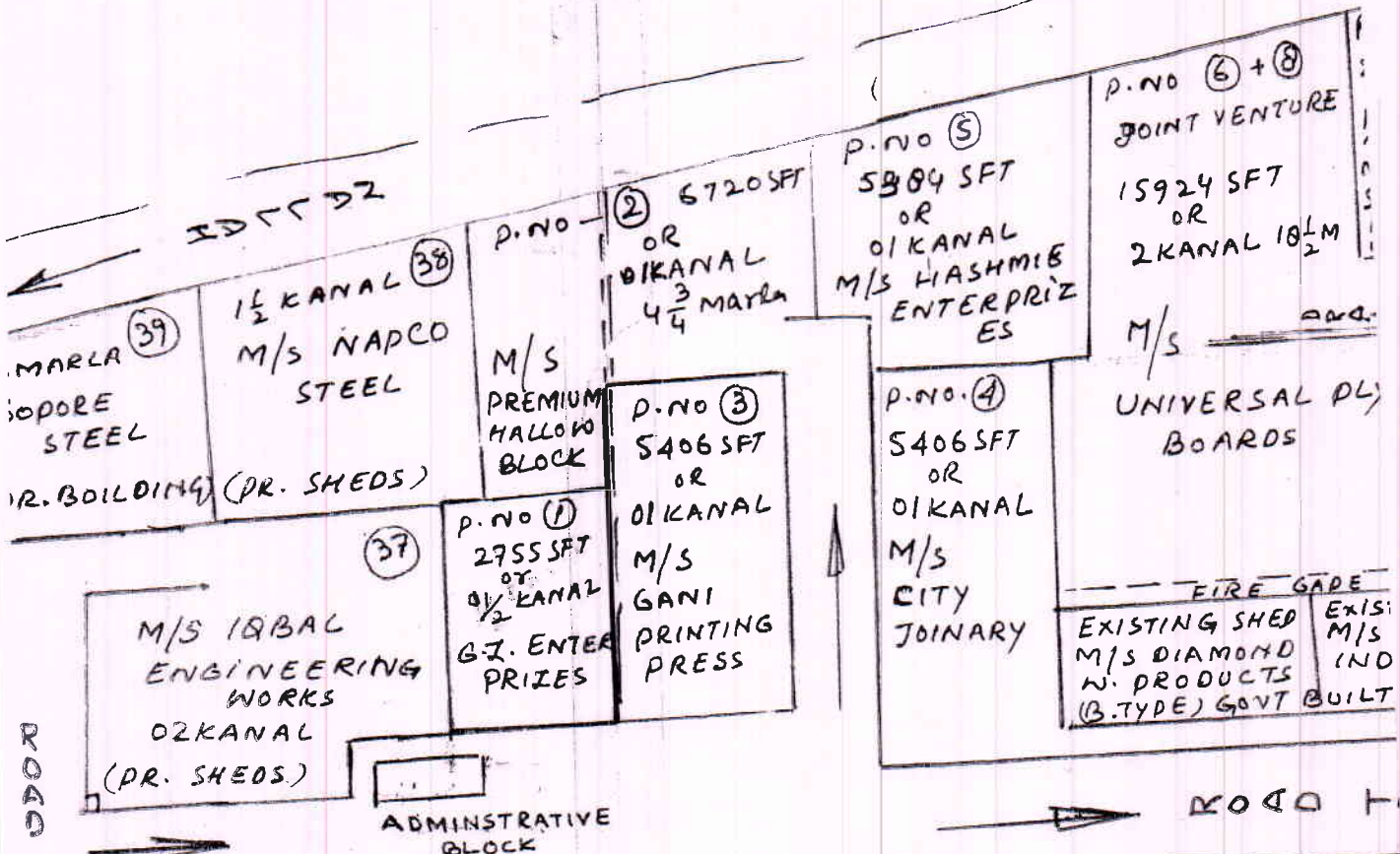

P.No. 7 2754 SFT OR 1/2 Kanal M/S Satalcal Alam cattle

P.No. 10 2804 SFT OR 10 1/2 MAR M/S ZAKI STEEL IND.

P.No. 11 3060 SFT OR 14 Marla M/S UKAZ Adcom

P.No. 12 2723 SFT OR 1/2 Kanal DREAMLAND FURNITURE

P.No. 13 2723 SFT OR 1/2 Kanal JASMINE ENTERPRIZES

P.No. 14 2737 SFT OR 1/2 Kanal SALMANIA STEEL

5472 SFT M/S STAR ICE CREAM (01 Kanal) P.No. (15+16)

P.No. 9 5357 SFT OR 01 Kanal M/S DIAMOND FOOD PRODUCTS

ISTING SHED 15 A.R.M INDUSTRIES LT (B-TYPE) 660 SFT

PRIV. ATE SHED 660 SFT

P.No. 17 2720 SFT OR 1/2 Kanal SYGICATE SPORTS GOODS

P.No. 18 2720 SFT OR 1/2 Kanal M/S JUNIAD MEHRAJ

P.No. 19 5440 SFT OR 01 Kanal M/S ESS-EHH-ELECTRI-CALS

P.No. 20 3354 SFT OR 12 1/4 M M/S ASEEF ENGINEERING WORKS

P.No. 21 5471 SFT OR 01 Kanal M/S KASHMIR DOULTARY & CATTLE FEED

P.No. 22 3128 SFT OR 11 1/2 M M/S DAR STEEL

P.No. 23 P. SHED 5440 SFT OR 01 Kanal M/S MASS ENTERDR-IZES

TO WNT.

ARK FOR INDUSTRIAL STATES

VERHEAD WATER STORAGE TANK

ROAD

DRAIN

A-TYPE GOVT. SHED M/S ANARALI SOAP

A-TYPE SHED ALPINE W.PROD.

F. (2A) P.No. ALPINE WOOD PRODUCTS 03 Kanal

P.No. 25 M/S NEW LIGHT BAKERY 01 Kanal

F.G.P.N. EXISTING GOVT. SHEDS 02 NO M/S KUHARK MELAL INDUSTRIES

PROP: MUDASIR FAYAZ

GRAVE-YARD

01 Kanal M/S P.No. 26 EMM-EYE ENTERPRIZES

03 Kanal M/S BAC ENGIN (P.R.S)

TRANSFORMER FOR ESTATE

MA ROAD

GRI

Q

GRAVE YARD

YARD

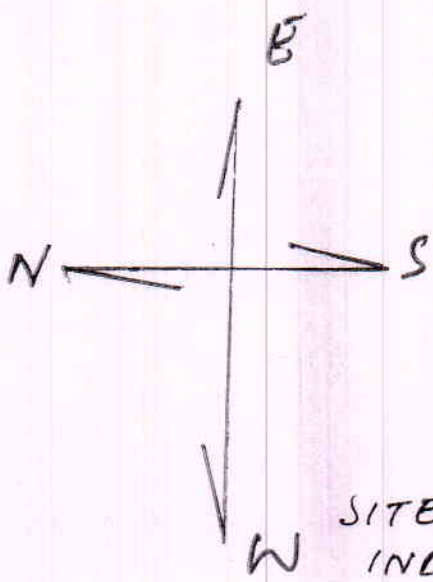

SITE PLAN OF INDUSTRIAL ESTATES SOPORE

Dist. S/C Industrial Estate Sopore

S. B. Bacha
P. No. 27
51374

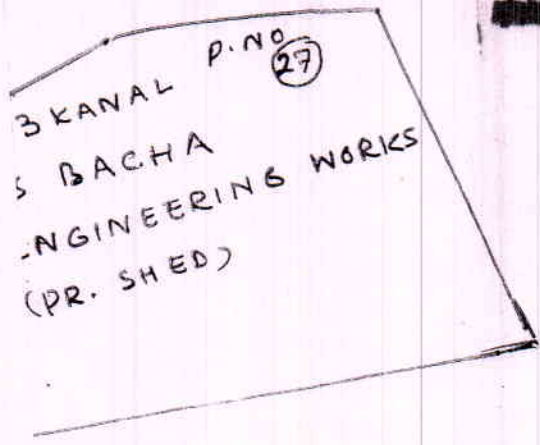

2